

LANDPOD[®]

PRICE LIST





THE COSY COCOON

From £5,000 +VAT

DESCRIPTION	PRICE
Main Structure + Waterproof Panels Thermal Insulation Roof, Rebated Wooden Floor, Carpet, Blackout Curtains, Composit Aluminium Finished Panels.	£4,200
Off Grid Electronic Pack Integrated LED Lighting System, Exterior Solar Light, Solar Power System, Landpod Power Hub & USB Chargers	£500
Adventure Pack Bug Netting, Canopy Poles	£300

Optional Extras

- Foam double mattress with waterproof cover 195 x 120 x 10 cm + £195
- Premium timber cladded roof +£300



THE POD FATHER™

From £9,000 + VAT

DESCRIPTION	PRICE
Main Structure + Waterproof Panels Thermal Insulation Canvas, Rebated Wooden Floor, Carpet, Blackout Curtains, Composite Aluminium Finished Panels.	£8,200
Off Grid Electronic Pack Integrated LED Lighting System, Exterior Solar Light, Solar Power System, Landpod Power Hub & USB Chargers	£500
Adventure Pack Bug Netting, Canopy Poles	£300

Optional Extras

- 2 x Foam double mattress with waterproof cover 195 x 120 x 10 cm + £380
- Premium timber cladded roof +£500



THE WOODLAND LODGE

From £12,000 + VAT

DESCRIPTION	PRICE
Main Structure + Waterproof Panels Thermal Insulation Canvas, Composit Aluminium Finished Panels, Rebated Wooden Floor, Bunk Beds, Carpet, Blackout Curtains	£10,900
Off Grid Electronic Pack Integrated LED Lighting System, Exterior Solar Light. Solar Power System, Landpod Power Hub & USB Chargers	£600
Adventure Pack Boot Holder, Herb Planter, Bug Netting, Canopy Poles	£500

Optional Extras

- 2 x Foam double mattress with waterproof cover 195 x 120 x 10 cm + £380
- 2 x Foam seating with waterproof cover + £295
- 2 x Sets Seat Cushions + £295
- Birch Games Table + £420
- Oak Table and Wine Rack + £420
- Premium timber cladded roof +£500



THE BUNK HOUSE

From £15,000 + VAT

DESCRIPTION	PRICE
Main Structure + Waterproof Panels Thermal Insulation Canvas, Composit Aluminium Finished Panels, Metal Adjustable Legs & Base, Timber Frame, Wooden Rebated Floor With Oil Protection, Metal Entrance Steps, Solid Aluminium Door, Blackout Curtains	£13,900
Off Grid Electronic Pack Integrated LED Lighting System, Exterior Solar Light, 60w Solar Panel System, Landpod Power Hub & USB Chargers	£1,100
Adventure Pack Boot Holder, Herb Planter, Bug Netting, Canopy Poles	£1,000

Optional Extras

- **Solid Roof:** Premium Timber Cladded Roof + £959
- **Comfy Mattresses:** 2 x Memory Foam Double Mattress + Waterproof Cover (195 x 120 x 10cm) + £380
- **Single Bunk Beds:** Standard UK Single Bunk Bed + £195 each
- **Storage Lockers:** Double Locker System + £280 each



THE EDEN LODGE

From £20,000 + VAT

DESCRIPTION	PRICE
Main Structure + Waterproof Panels Thermal Insulation Canvas, Composit Aluminium Finished Panels, Rebated Wooden Floor, Bunk Beds, Carpet, Blackout Curtains, Durable Plastic Coated Steel Roof.	£18,400
Off Grid Electronic Pack Integrated LED Lighting System, Exterior Solar Light, Solar Power System, Landpod Power Hub & USB Chargers	£1,100
Adventure Pack Boot Holder, Herb Planter, Bug Netting, Canopy Poles	£500

Optional Extras

- 5 KW Saltfire Wood Burning Stove & Flue System (purchasing direct from supplier) + £1,595
- Premium timber cladded roof +£500
- 2 x Foam double mattress with waterproof cover 195 x 120 x 10 cm + £380
- 2 x Foam seating with waterproof cover + £295
- 2 x Sets Seat Cushions + £295
- Oak Table and Wine Rack + £420
- Birch Games Table + £420
- Woodstove Package +£395



THE PRIVY POD

From **£1,850 + VAT**

DESCRIPTION	PRICE
Main Structure + Waterproof Panels Metal Roof, Plastic Cladded Flooring, Composite Aluminium Finished Panels, Timber Frame.	£1,400
Extras	
All Terrain Landpod Legs	£380
Aluminium Steps	£195
Off grid electric pack Intergrated LED Lighting System, 30watt Solar Panel, 12volt attery.	£225

Compatible Toilets:	
• Long drop composting toilet	£750
• Chemical loo	£400
• Mains flushing toilet	£130
Compatible Showers:	
• LPG Gas shower	£200 - £400
• Wall mounted shower panel	£200
• Undercarriage shower tray with carbon filter	£180
• Pallet Delivery - UK Mainland	£180



THE GARDEN BAR

From £1,850 + VAT

DESCRIPTION	PRICE
Main Structure + Waterproof Panels Composit Aluminium Finished Panels, Timber Frame, Durable Plastic Coated Steel Roof, Solid Oak Shelving, Vibrant LED Strip Lighting.	£1,850

Optional Extras

- Iconic Adjustable Landpod Base with 4 Legs + £1,500
- Off Grid Outdoor Sink + £250



THE DINING POD

From £9,000 + VAT

DESCRIPTION	PRICE
Main Structure + Waterproof Panels Thermal Insulation Canvas, Rebated Wooden Floor, Composit Aluminium Finished Panels, Durable Plastic Coated Steel Roof, Window Shutters.	£8,050
Off Grid Electronic Pack Integrated LED Lighting System, Exterior Solar Light, Solar Power System, Landpod Power Hub & USB Chargers	£600
Adventure Pack Bug Netting, Herb Planter, Canopy Poles	£350

Optional Extras

- Premium timber cladded roof +£300
- 2 x Sets Seat Cushions + £295
- Oak Table and Wine Rack + £420



THE SHOWER / TOILET POD

From £12,000 + VAT

DESCRIPTION	PRICE
Main Structure + waterproof panels Steel Roof, Non-Concussive Shower, Benches, Entrance Steps	£11,500
Off Grid Electronic Pack LED lighting system, Solar Power System, Landpod Power Hub Switch	£500

Optional Extras

- Premium timber cladded roof +£300

Toilet options:

- Compostable toilet (price range £350-£780)
- Standard toilet (needs mains water supply and provision for waste disposal, septic tank)

Shower heating options:

- LPG gas boiler system (price range £100-£300) LPG Gas bottle required
- Electric Instant Shower system (price range £150-£300) Mains electric required



THE POWER POD

From £10,000 + VAT

DESCRIPTION	PRICE
Main Structure + Waterproof Panels <ul style="list-style-type: none"> • 3m x 1.5m All Terrain Landpod structure with 3 lockable doors • Front canopy and timber clad structural roof • Unbraked lightweight transporter/trailer • 3 x 350 watt split cell Monocrystalline solar panels. 1kw in parrallel • 400 watt Wind turbine • 80A MPPT solar controller and temp senor • 80A DC circuit breakers, earthing rod, 60A battery guard, 60A circuit breaker for battery guard plus all necessary fusing and cabling • 2 x 12 volt hook up points for remote power • DC to AC inverter 3kw • External Hook up point to charge electric bikes and vehicles • Pull out shelf for fridge, Automatic courtesy lighting. <p>N.B. The electrical system must be tested by a competent electrician before use and annually thereafter.</p>	£10,000

THE BATTERIES WILL NEED TO BE PURCHASED DIRECT FROM THE SUPPLIER:

We suggest the following: Deep cycle battery bank (1 x 200AH AGM) Approx £230.

We suggest 4 in parallel which will give approx 10kWh of battery storage



THE CAMPFIRE

From **£750 + VAT**

DESCRIPTION	PRICE
Barbeque The campfire pit for toasting marshmallows or add the griddles on top to get sausages sizzling.	£750
Barbeque and Bread Oven Complete with a griddle on top for BBQing and a bread oven below. A hinged door at the back for easy access to the fire to keep them pizzas rising high!	£1,500
Warming the heart of your outdoor adventure, our new campfire has the magic Landpod adjustable legs which enable you to cook safely off the ground (however wonky) AND to adjust the height to keep all your important bits warm too.	

OPTIONAL EXTRAS:

There is an option to customise a side panel of the Landpod Campfire as a special request + £50

POD FATHER, COSY COCOON AND ALFRESCO POD DIMENSIONS & FLOOR PLANS

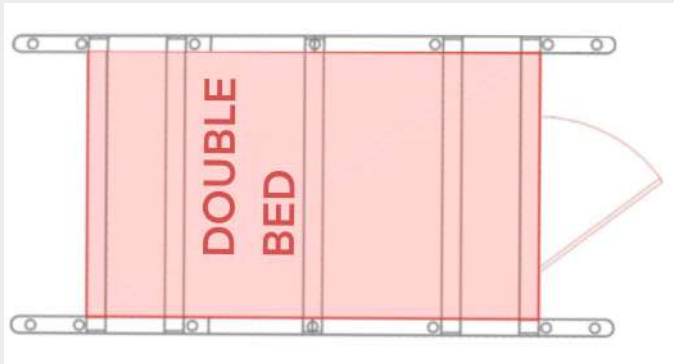

THE COSY COCOON

INTERNAL:

LENGTH: 2800MM

WIDTH: 1500MM

HEIGHT: 2000MM

EXTERNAL:

LENGTH: 3000MM

WIDTH: 1500MM

HEIGHT: 2000MM

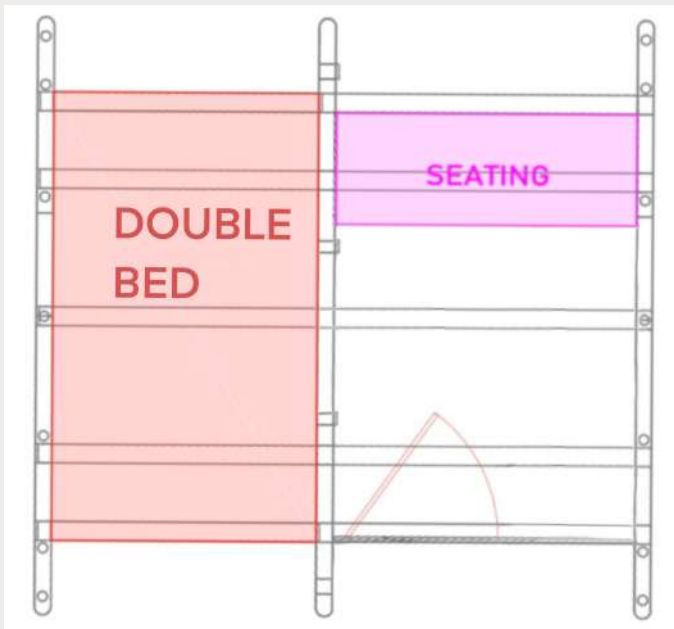

THE POD FATHER

INTERNAL:

LENGTH: 3000MM

WIDTH: 2800MM

HEIGHT: 1300MM

EXTERNAL:

LENGTH: 3000MM

WIDTH: 3000MM

HEIGHT: 1500MM

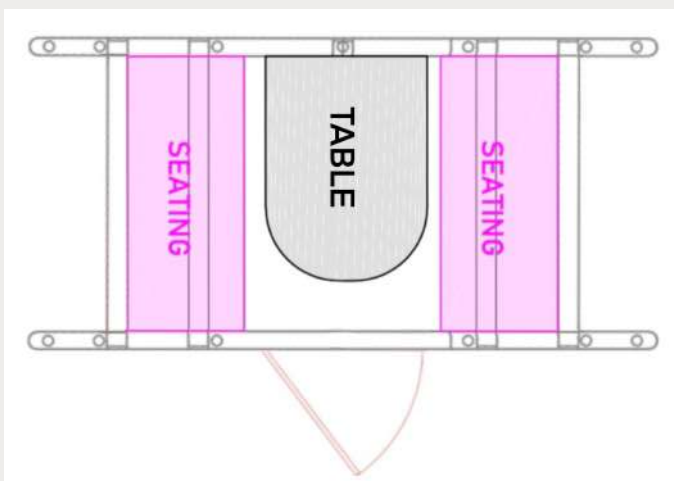

THE DINING POD

INTERNAL:

LENGTH: 2100MM

WIDTH: 1220MM

HEIGHT: 1875MM

EXTERNAL:

LENGTH: 3000MM

WIDTH: 1500MM

HEIGHT: 2100MM

THE WOODLAND LODGE DIMENSIONS & FLOOR PLANS

THE WOODLAND LODGE

INTERNAL:
LENGTH: 3000MM
WIDTH: 2800MM
HEIGHT: 2100MM

EXTERNAL:
LENGTH: 3000MM
WIDTH: 3000MM
HEIGHT: 2400MM

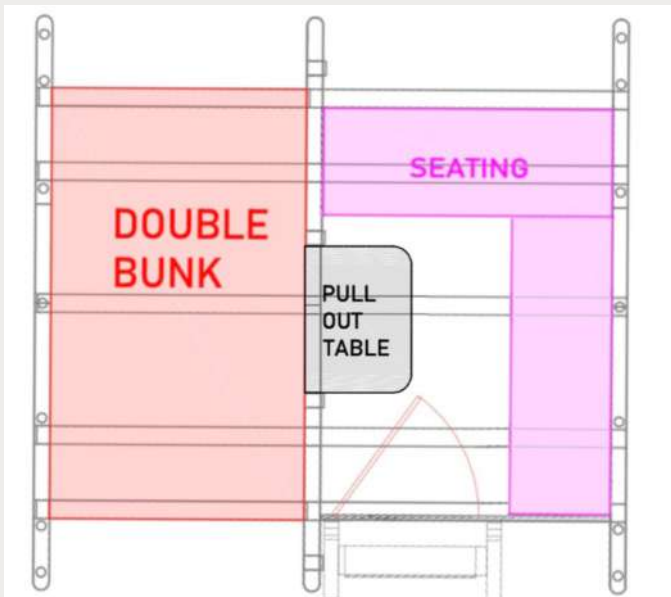

Option 1

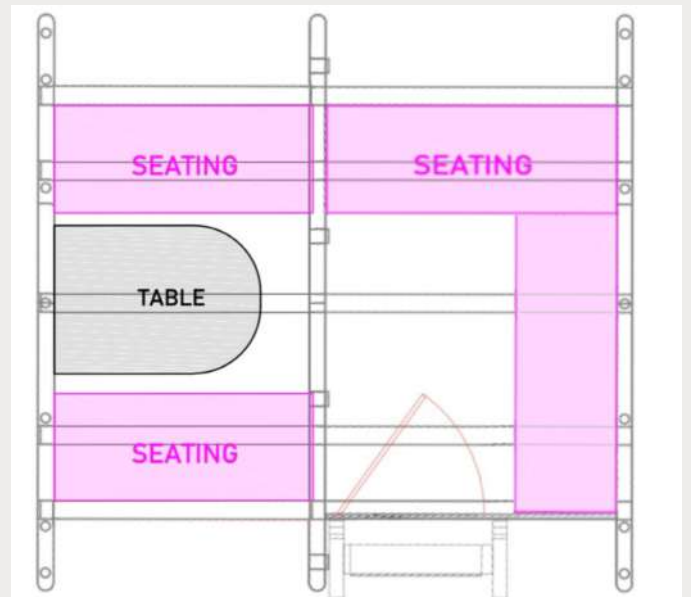

Option 2

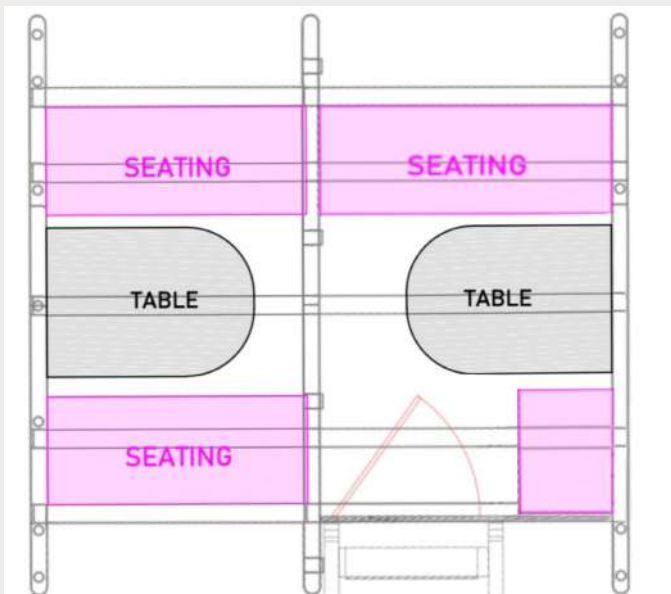

Option 3

HOW TO CONTACT US

WEBSITE: WWW.LANDPOD.CO.UK

JAKE: 07804 243 565
STEVE: 07715 728 967

EMAIL: INFO@LANDPOD.CO.UK

EDEN LODGE

DIMENSIONS & FLOOR PLANS

THE EDEN LODGE

INTERNAL:
LENGTH: 2100MM
WIDTH: 4200MM
HEIGHT: 1875MM

EXTERNAL:
LENGTH: 3000MM
WIDTH: 4500MM

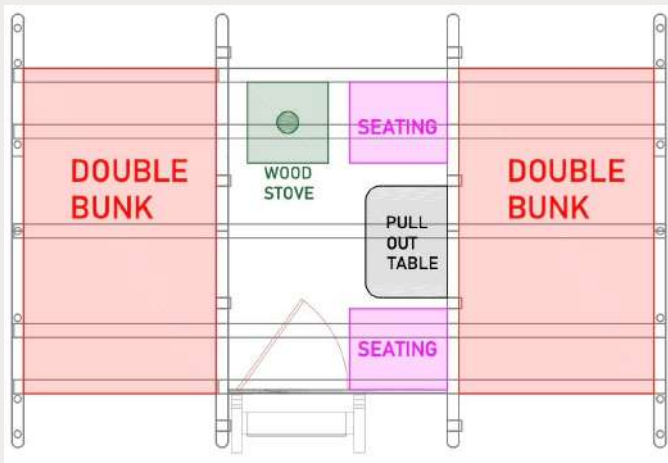

Option 1

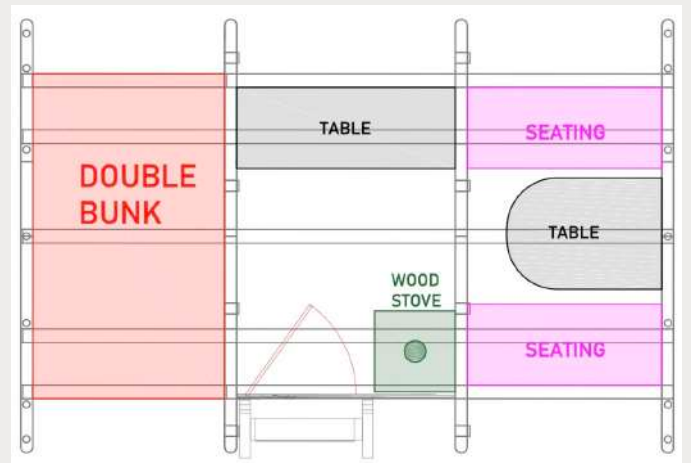

Option 2

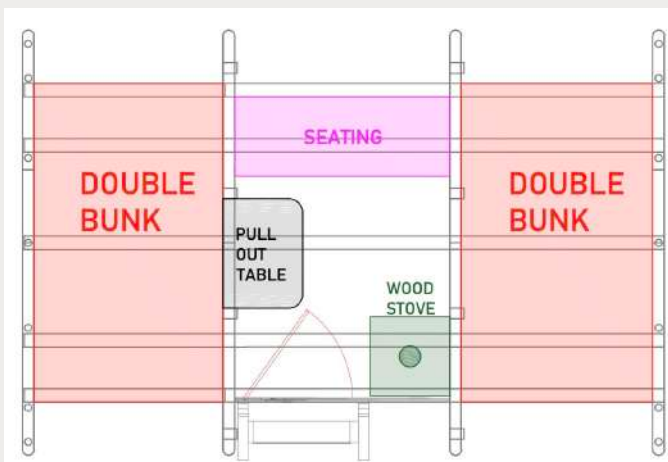

Option 3

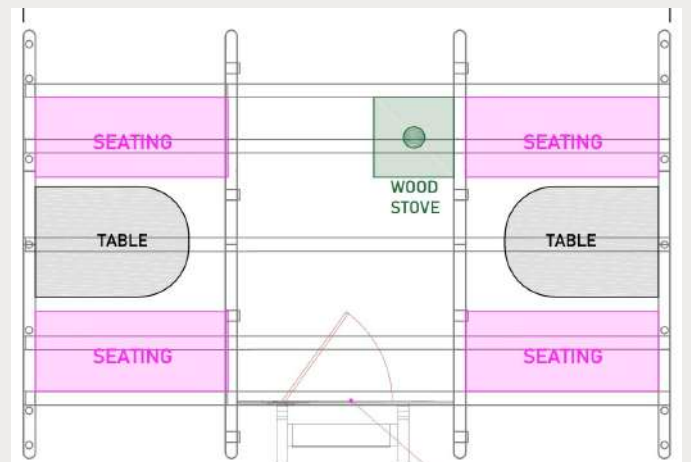

Option 4

THE BUNK HOUSE

DIMENSIONS & FLOOR PLANS

THE BUNK HOUSE

INTERNAL:
LENGTH: 5200MM
WIDTH: 2800MM
HEIGHT: 2200MM

EXTERNAL:
LENGTH: 6000MM
WIDTH: 3000MM
HEIGHT: 2300MM

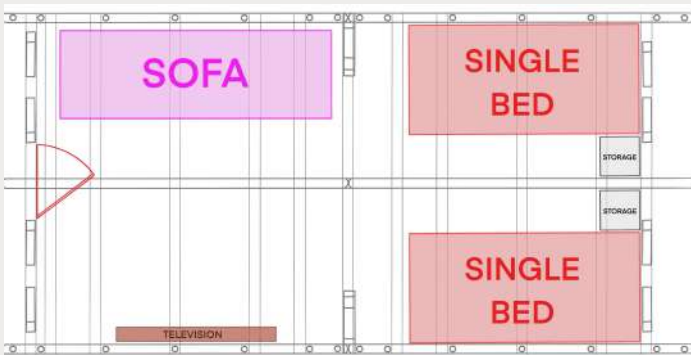

Option 1

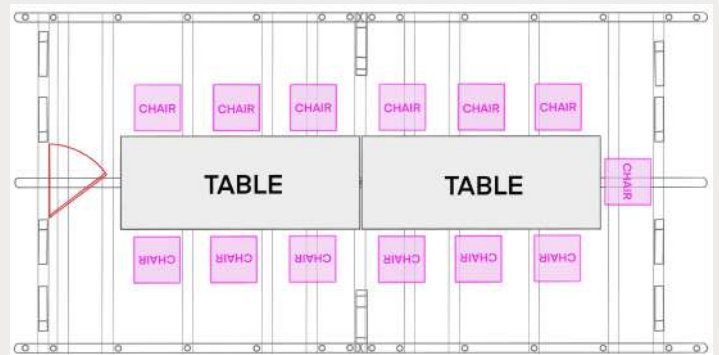

Option 2

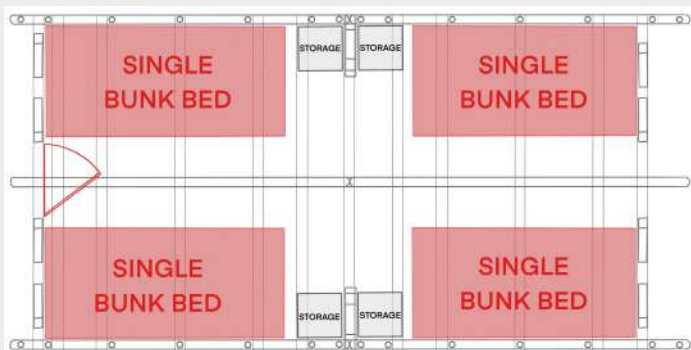

Option 3

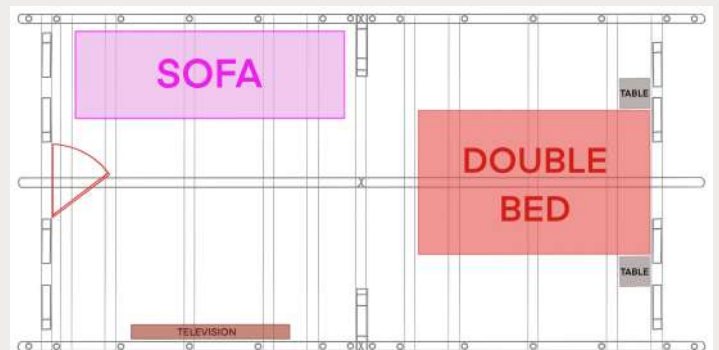

Option 4

LANDPOD CAMPING CLUB

Who is Landpod Camping Club?

Natural England along with the Scottish and Welsh Government have granted Landpod Camping Club a license to certify suitable land with an exemption. This certificate (subject to survey) allows your proposed site to be certificated for a 12- month period, enabling the recreational exclusive use of Landpod Products earning you an income.



What is an Exemption Certificate?

This certification provides an excellent opportunity to generate an income from your land by offering an exclusive glamping experience. Additionally, it could serve as valuable evidence of success if pursuing a more permanent planning application in the future.

What will happen next?

While our exemption certification eliminates the need for an application to the local Planning Authority or National Park, we do inform them during the survey process to request their comments. They have a 28-day notice period to respond, and if no response is received, we move forward with Stage 3. When completing the application form, please provide detailed information about the accommodation you plan to have on-site. Our certified sites are committed to maintaining their aesthetic integrity and ensuring they do not resemble a typical camping menagerie. These standards will be upheld throughout the certification period, in line with the clubs Constitution and Code of Conduct.

Professional Charges

1

Desk Study Assessment - No Charge

2

Site Notice - £300 + VAT

3

Site Visit - £200 + VAT

4

Landpod Camping Club Certification - £200 + VAT

5

Certification Renewal (Annual) - £200 + VAT

LANDPOD[®]



Check out our website for more! www.landpod.co.uk

Get in touch: info@landpod.co.uk

Barlaston, Staffordshire